

EMERGENCY RAIL ON TILE ROOF WITH UNDERLAYS OF TONGUE-IN-GROOVE BOARD MIN 17 MM OR OF PLYWOOD MIN 12 MM



Foot plate

Distance between brackets 600-900 mm.

Attach the bracket to the foot place with screw (A x 2), washer (B x 4) and nut (C x 2).

Adjust the footplate between the battens so that the correct height toward the roof tile is obtained.

Fasten the foot plate in place with wood screws (E x 10) evenly distributed over the foot plate.

Use a screwdriver with a depth gauge to prevent damaging the threads.

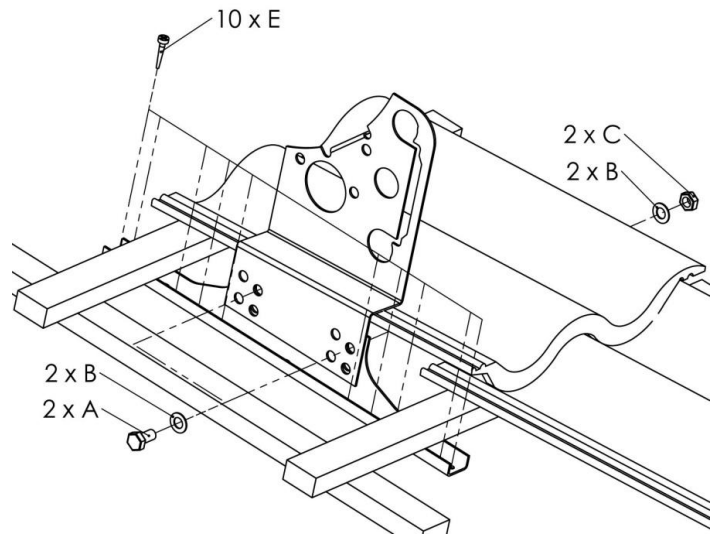

Emergency rail 1 m

Pass the rail tube through the consoles.

Max protrusion from the outermost bracket 200 mm.

At one end of the rail, the locking plate is attached with a screw (A x 1), washers (B x 2), nut (C x 1) and screw (D x 2).

At the other end of the rail, the other locking plate is attached on the outside of the outermost bracket on the tube using screws only (D x 2).

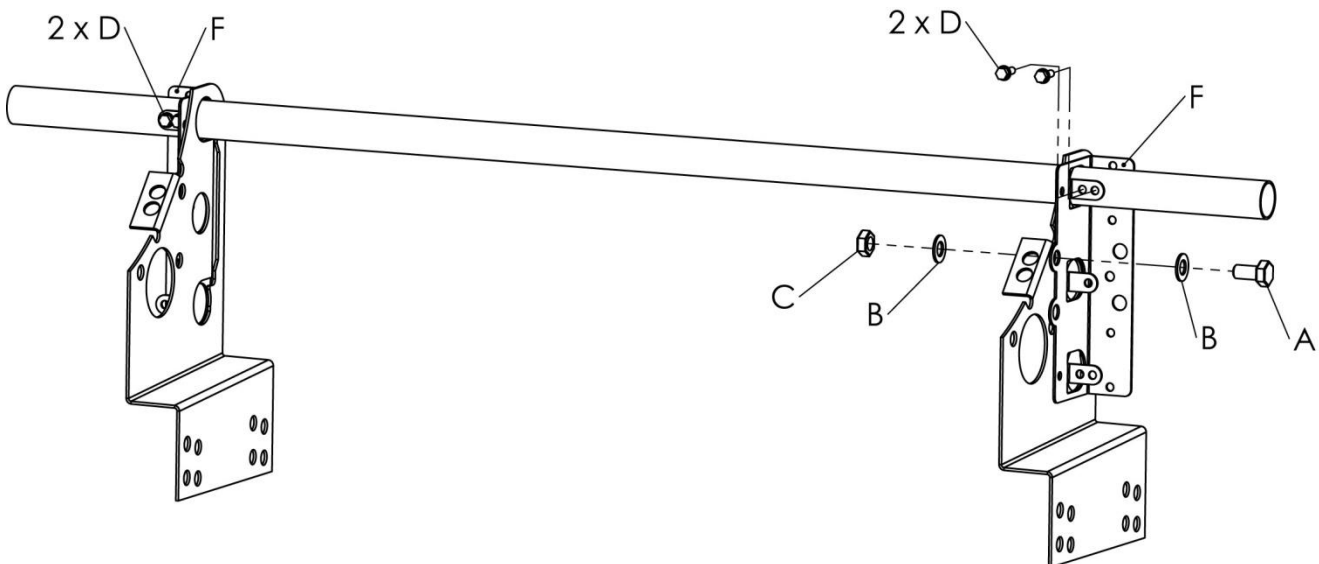

The ridge rail is designed and rated for the attachment of one person with personal fall protection equipment.

When cutting products, the cut surfaces must be coated with rust-protective paint.

A= Screw hot galv. M10 x 20, **B=** Washer hot galv. 10.5 mm, **C=** Washer hot galv. M10, **D=** Self-tapping stainless screw 20 x 5.5 mm, **E=** Stainless wood screw 35 x 4.8 mm, **F=** Locking plate